

**isolite**  
core / isovac hose  
HVE Hose Kit

1 Determine HVE connection technique for the Isolite Hose.

**A** Direct connection to open port on vacuum canister.

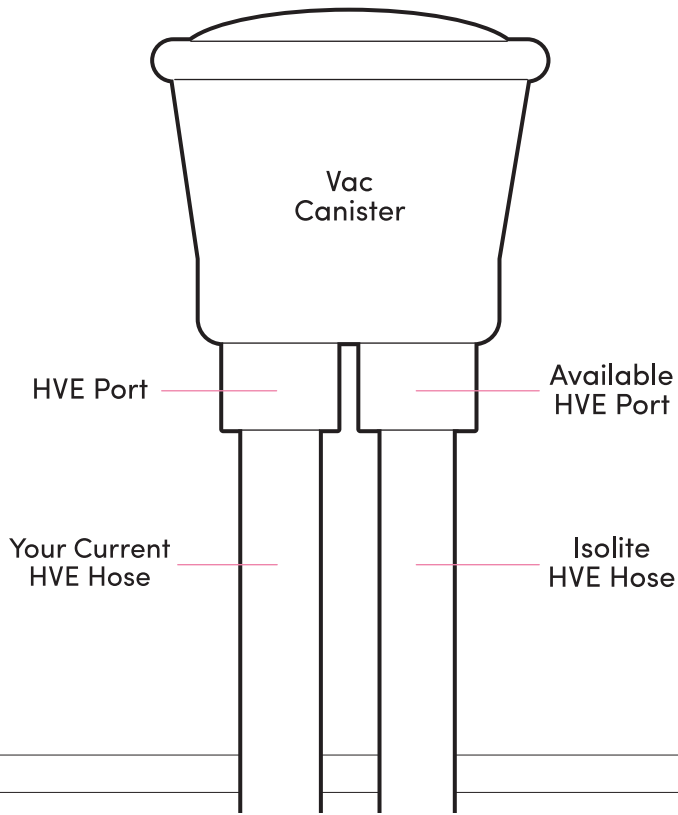

OR

**B**

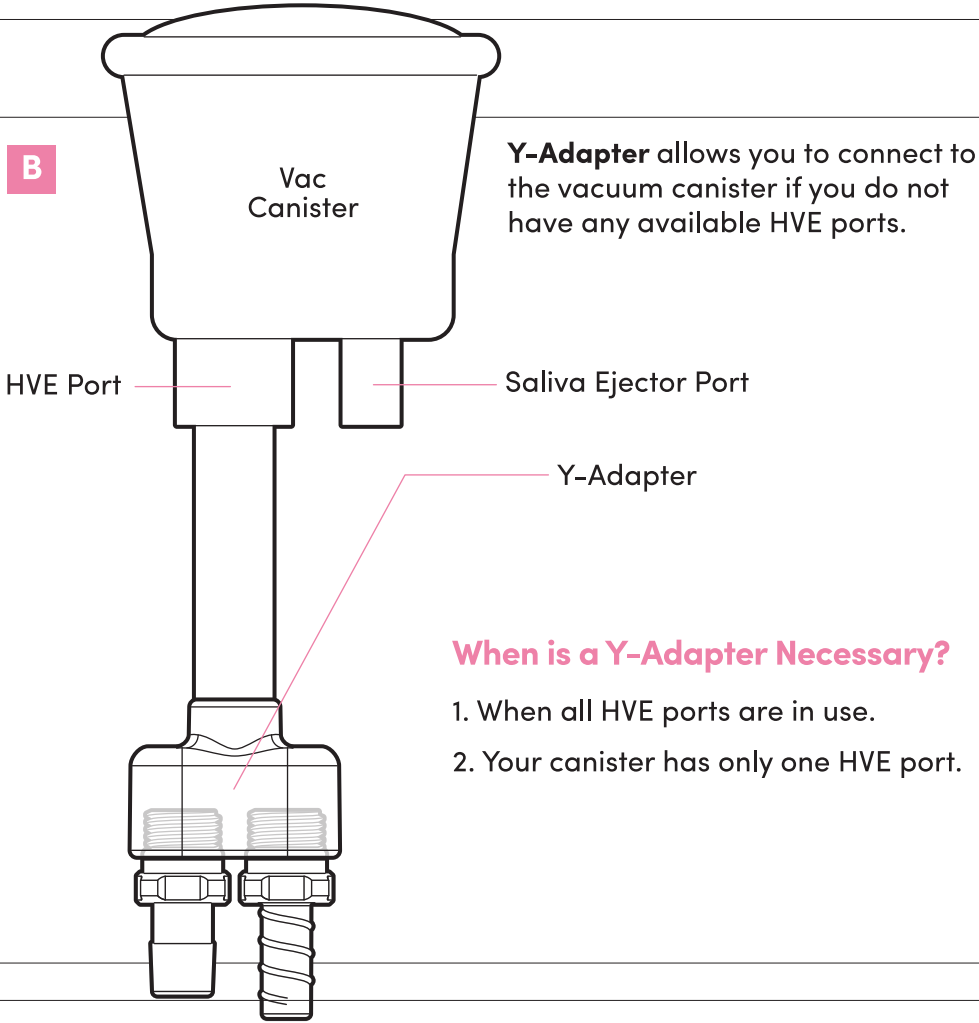

**Y-Adapter** allows you to connect to the vacuum canister if you do not have any available HVE ports.

**When is a Y-Adapter Necessary?**

1. When all HVE ports are in use.
2. Your canister has only one HVE port.

2 **IMPORTANT:** Make sure your vacuum system is turned off before starting.  
**NOTE:** If the 6" tubing doesn't fit your vacuum port, some chair models require a tailpiece reducer cap that you can order from your distributor.

**A** Installation instructions for direct connection to open vacuum port on vacuum canister.

- 1 Connect Isolite HVE Hose to coupler.
- 2 Connect the HVE Tubing to the open port.
- 3 Holster the HVE valve end of the hose in a convenient location on toolbar.
- 4 Turn on vacuum system and test.

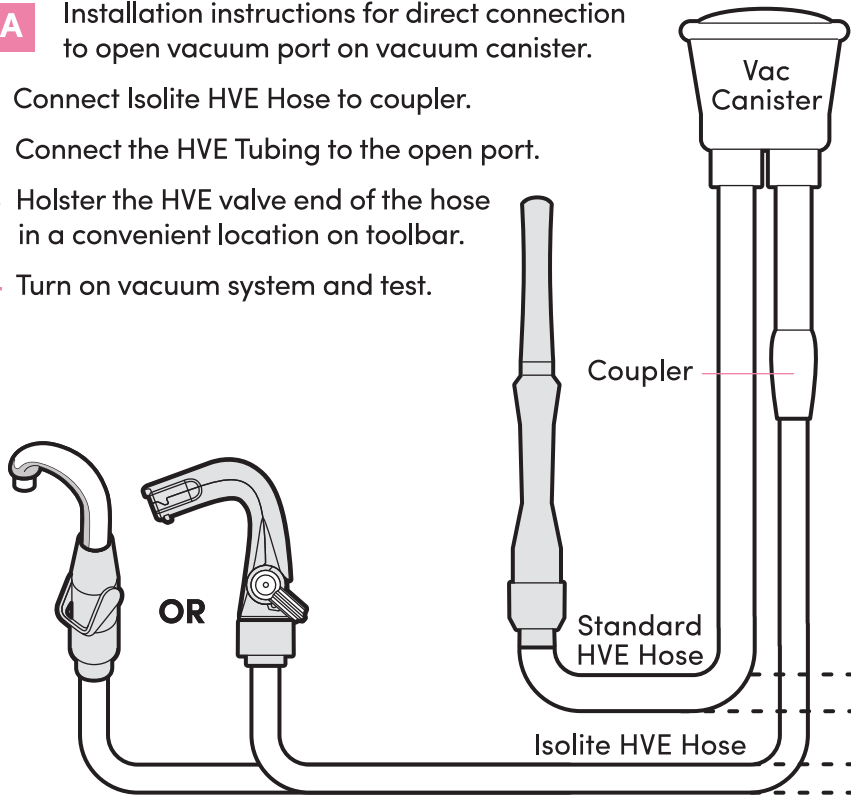

OR

**B** Installation Instructions with Y Adapter.

- 1 Connect the Isolite HVE Hose to the spiral barb on bottom of Y-Adapter.
- 2 Remove your current HVE hose from the vacuum canister and connect it to the standard barb on bottom of the Y-Adapter. **NOTE:** If your current HVE hose end is loose on barb fitting, cut off 1" and then connect onto barb fitting.
- 3 Connect the HVE tubing on the top of the Y-Adapter onto the open port you created. (Trim to desired length.) **TIP:** If tubing is difficult to connect to vacuum canister port, soak tube end in hot water a few minutes to make it more pliable.
- 4 Holster all control heads in toolbar.
- 5 Turn on vacuum system and test.

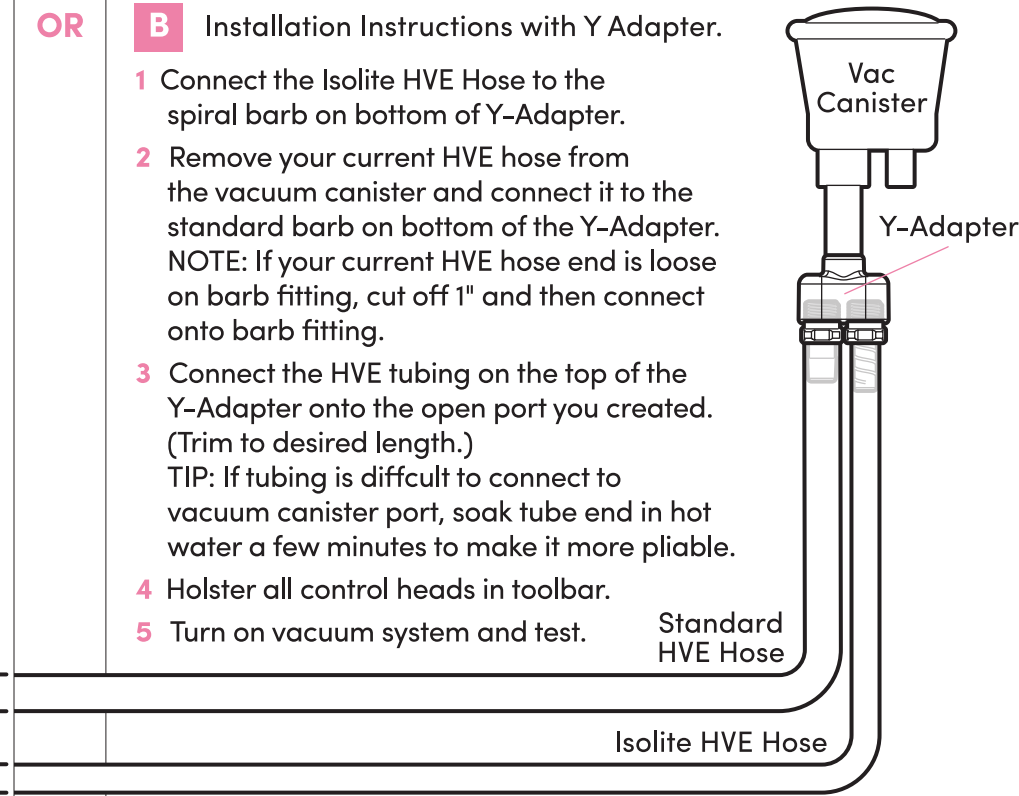



3 Cleaning and Disinfection

After each patient it is recommended to follow your standard protocols for cleaning your HVE Valve and Hoses. Zyris recommends performing a surface disinfection of the Isolite HVE Hose after each patient. Following the manufacturer’s instructions for contact time, use an intermediate level disinfectant wipe with a claim to inactivate Mycobacterium tuberculosis. Otherwise use a hospital grade disinfectant on all surfaces of the HVE Valve and Isolite HVE Hose to remove all visible biomatter and debris.

Periodic Maintenance

4 To clean HVE Valve:

- 1 Pull handpiece (valve) from swivel adapter.

2 Position lever at a 90° angle to valve.  
Remove by pulling up and back on one side only.

3 Push spool out either side.

4 Remove three o-rings, two from the spool and one from the lip of the valve.  
Use a sharp pointed instrument for this removal.

5 Pre-soak the valve, spool, o-rings and lever in an enzyme detergent cleaner or place in an ultra-sonic cleaner. Be sure that the detergent/ enzyme cleaner is compatible with soft metals. Bleach, iodophors, and phenol compounds will strip the finish from the valve, thus voiding the warranty.
- 6 Use a brush to remove debris from the inside of the valve, paying close attention to the slots for the o-rings.

7 Rinse and dry completely.

8 Place into autoclave pouch and autoclave using the validated sterilization cycles below.

9 Reassemble, replacing o-rings as needed. O-rings should be lightly lubricated with Dow 111 O-ring lubricant for smooth even operation of the lever.

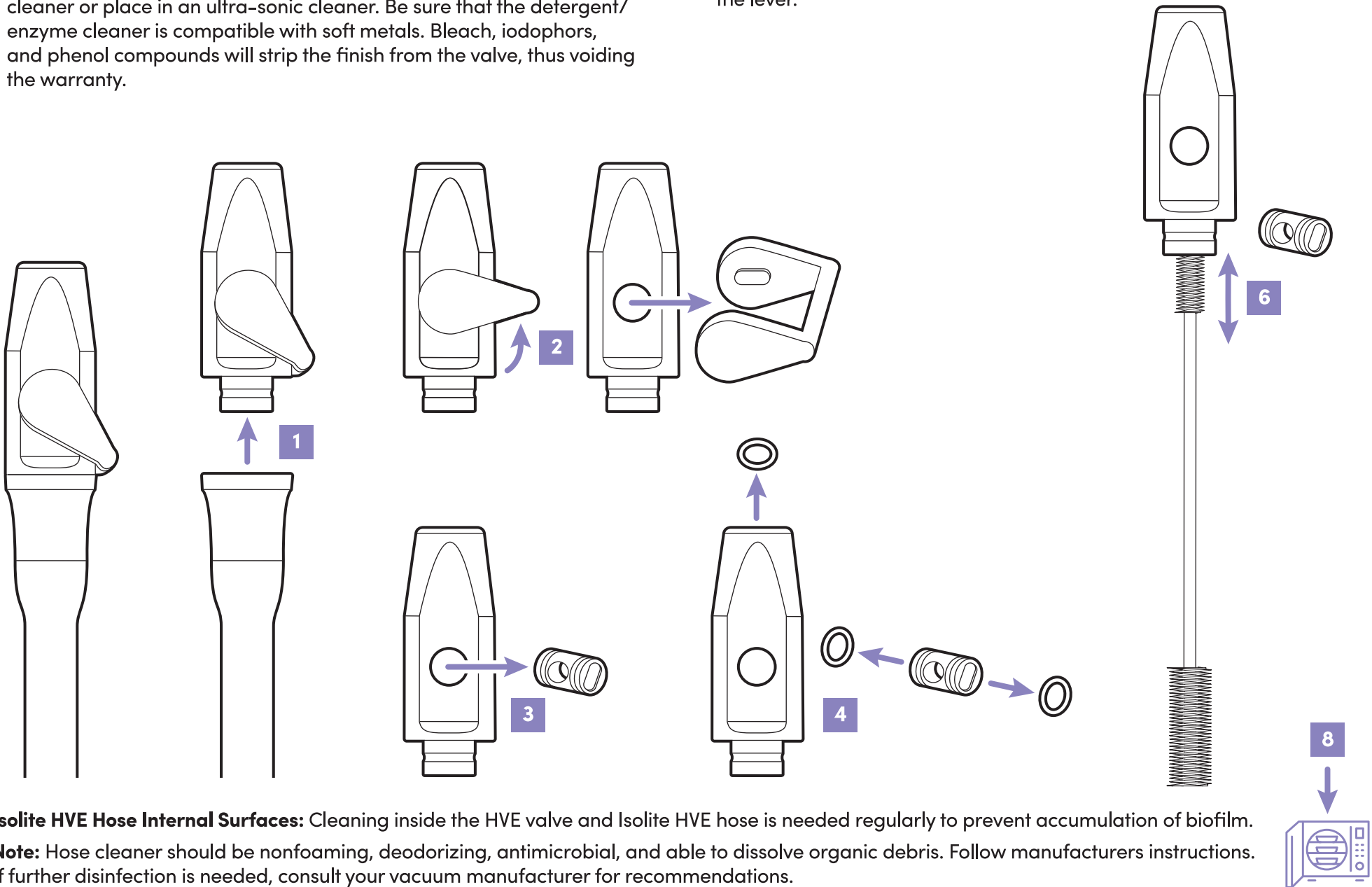

VALIDATED STERILIZATION CYCLES			
Cycle	Temperature	Minimum Exposure Time	Minimum Drying Time
Standard	121 °C / 250 °F	30 min	30 min
Standard	126 °C / 259 °F	10 min	30 min
Standard	132 °C / 270 °F	15 min	15 min
Prevacuum	132 °C / 270 °F	4 min	20 min
Prevacuum	134 °C / 273 °F	3 min	20 min

Video instructions can be found at:



<https://zyr.is/hose>



Limited 1-Year Warranty  
<https://www.zyris.com/warranty>

**ZYRIS**

6868A Cortona Dr  
Santa Barbara, CA 93117  
(805) 560-9888